

# Legacy Forest

AT LEXINGTON PARK

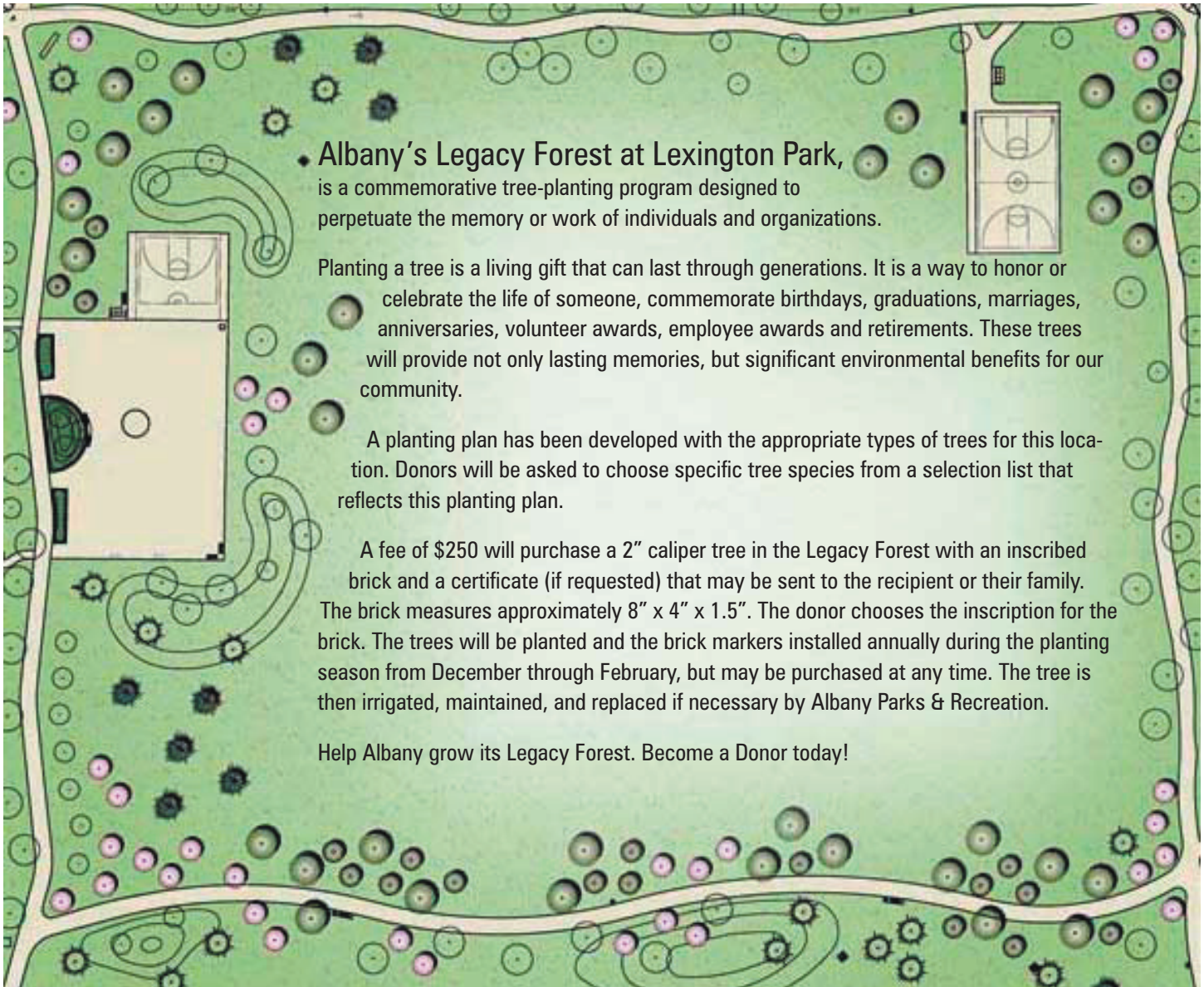

Albany's Legacy Forest at Lexington Park, is a commemorative tree-planting program designed to perpetuate the memory or work of individuals and organizations.

Planting a tree is a living gift that can last through generations. It is a way to honor or celebrate the life of someone, commemorate birthdays, graduations, marriages, anniversaries, volunteer awards, employee awards and retirements. These trees will provide not only lasting memories, but significant environmental benefits for our community.

A planting plan has been developed with the appropriate types of trees for this location. Donors will be asked to choose specific tree species from a selection list that reflects this planting plan.

A fee of \$250 will purchase a 2" caliper tree in the Legacy Forest with an inscribed brick and a certificate (if requested) that may be sent to the recipient or their family. The brick measures approximately 8" x 4" x 1.5". The donor chooses the inscription for the brick. The trees will be planted and the brick markers installed annually during the planting season from December through February, but may be purchased at any time. The tree is then irrigated, maintained, and replaced if necessary by Albany Parks & Recreation.

Help Albany grow its Legacy Forest. Become a Donor today!

## LEGACY FOREST TREE ORDER FORM

Donor's Name \_\_\_\_\_

Donor's Address \_\_\_\_\_

Donor's Daytime Phone \_\_\_\_\_

In Memory of \_\_\_\_\_

(Or) In Honor of \_\_\_\_\_ Occasion \_\_\_\_\_

Brick inscription: 3 lines, up to 16 characters per line

\_\_\_\_\_  
\_\_\_\_\_  
\_\_\_\_\_

Please send this order form and the fee of \$250 made payable to "Albany Parks & Recreation" to:  
**Legacy Forest**  
**Albany Parks & Recreation**  
**PO Box 490**  
**Albany, OR 97321**

